

biiSAFE

Site Safety

Secured by Technology

BiiSafe Site Safety



Schools and
campuses



Nursing homes
and rehabilitation
centers



Companies &
Organizations



Lone workers

Core features



ADMINISTRATION

Manage users, and groups.
Send messages and alerts.
Locate user in the map view.



PICTURE SHARING

Share pictures taken with
mobile phone in groups



MESSAGE SENDING

Send messages to the
selected group with the
mobile app and the portal.

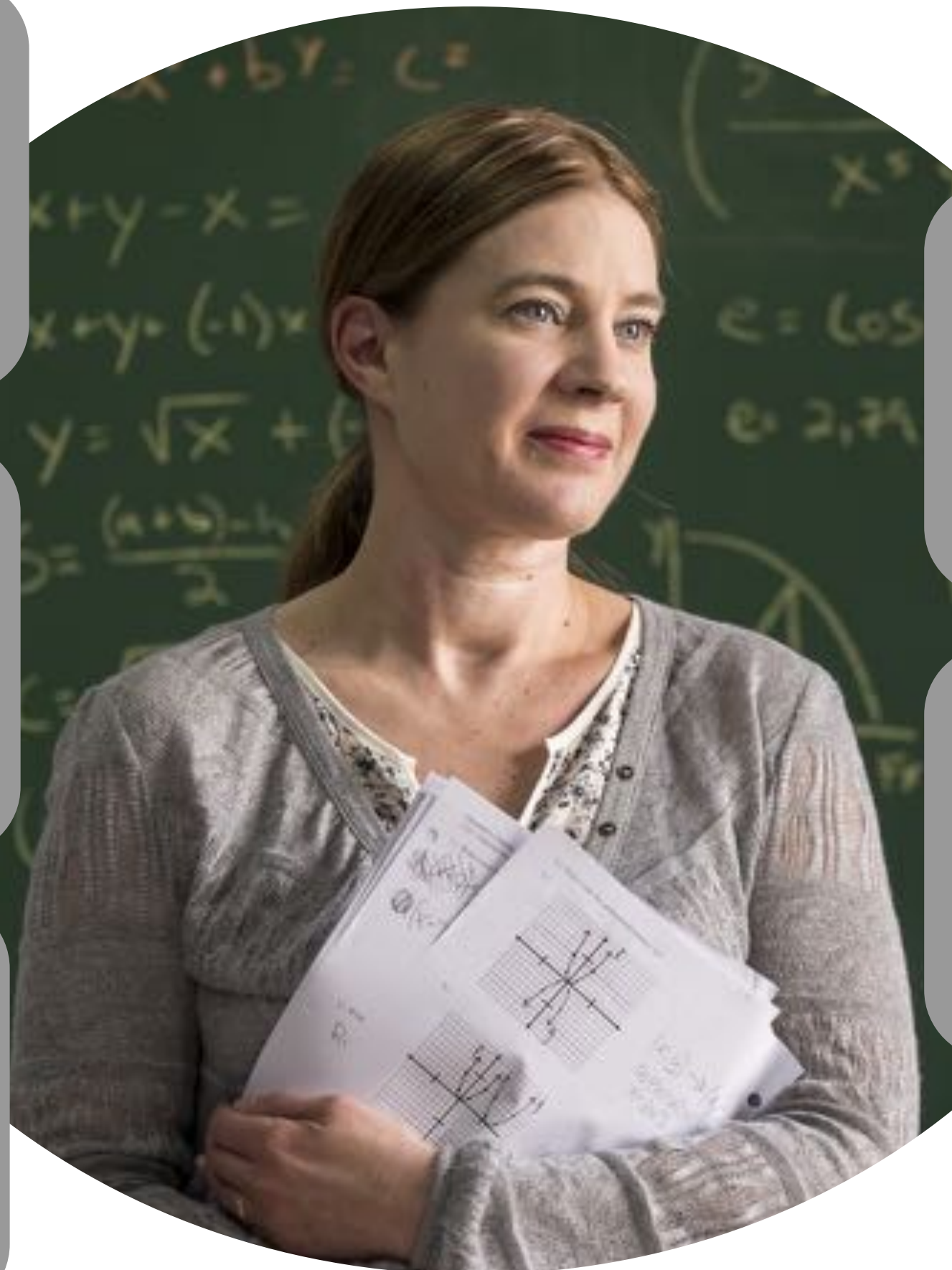

ALERTS

Send alerts with a panic button,
the mobile app or the portal to
selected group or 3rd party e.g.
security company



LOCATION SHARING

Locate user based on user's
mobile phone GPS
functionality or Biisafe Link



Why Biisafe Site Safety?



Ease of deployment

- Quick to set up
- Affordable and simple to use
- Flexible and scalable
- Fast and easy 3rd party integration

Sens of community

- Social coherence
- Improved feeling of safety
- Immediate help at site
- Preventing distressing situations

Components

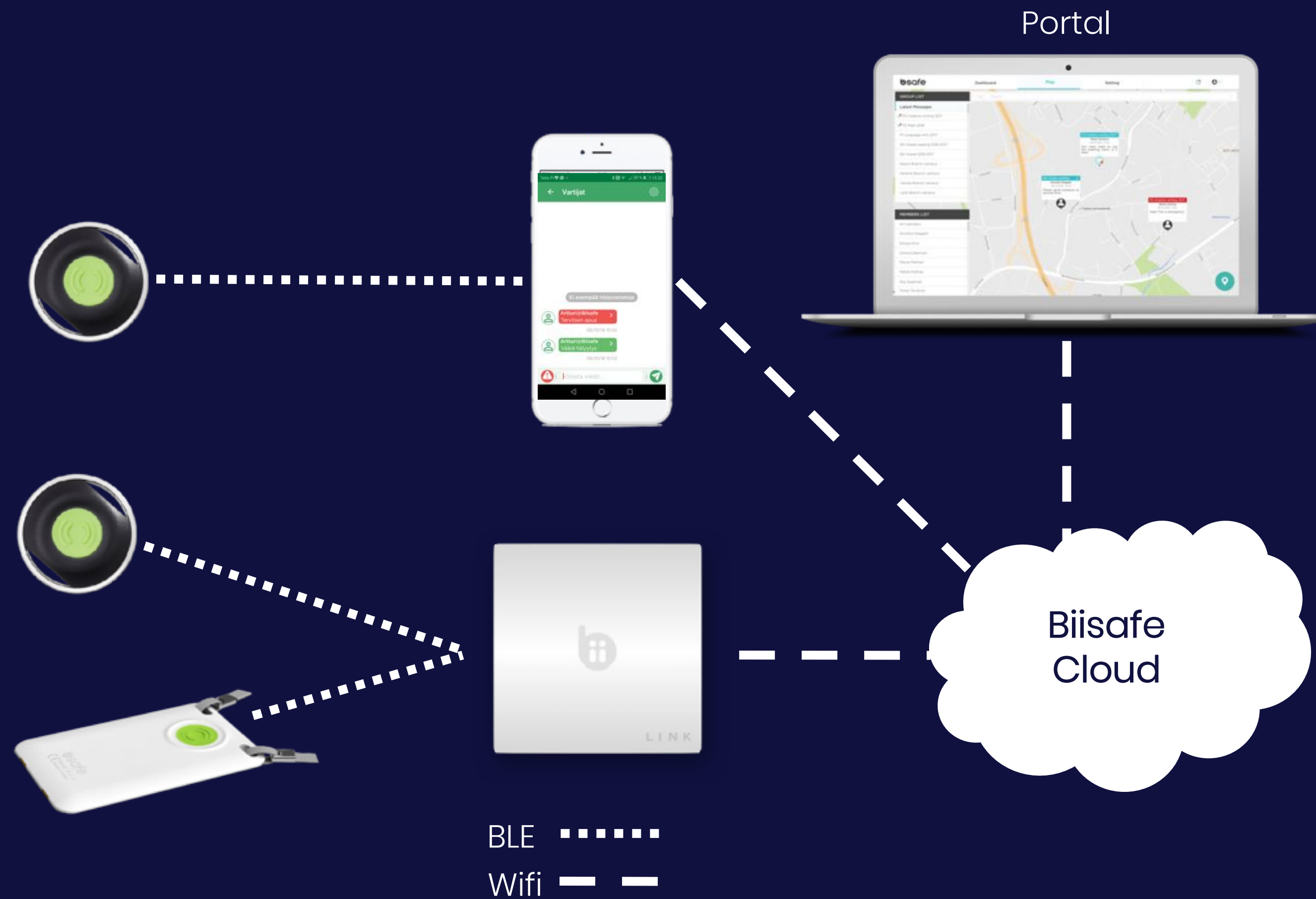

Biisafe Buddy/Card
Wireless panic button that sends alerts to the cloud via mobile phone or Link



Biisafe Safe mobile app
Google Play (Android)
Send messages or alerts to the cloud



Biisafe Link
Sends alerts to the cloud
Cover approx. 400m² that can be expanded by adding more units



Biisafe Portal

- Administration and messaging portal used with a browser
- User management and group creation
- Alert sending and locating people
- Group messages
- SMS alerts
- Can be integrated to 3rd party call center
- Compatible with Biisafe Buddy, Biisafe Card, Biisafe Link

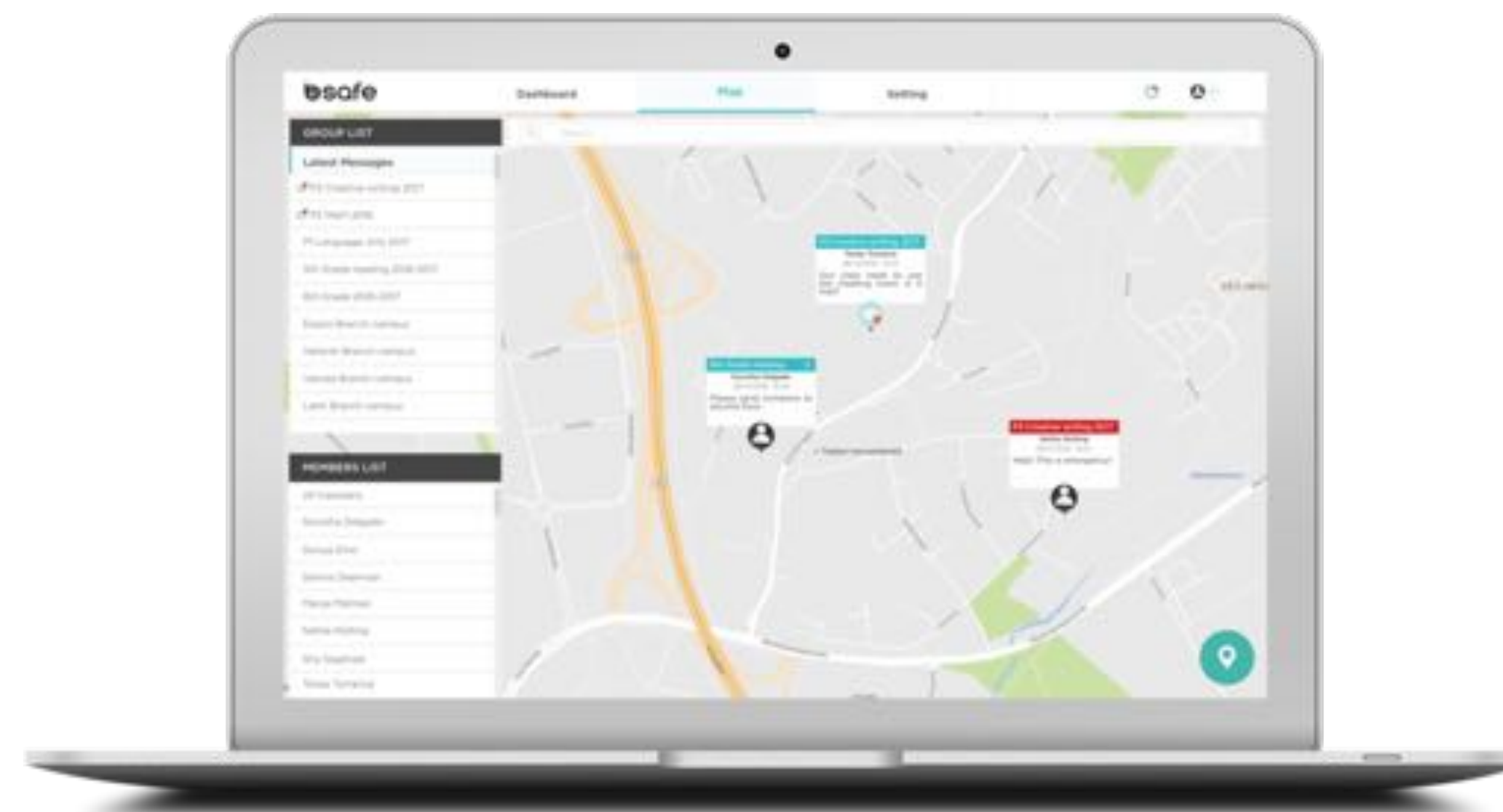

BiiSafe Safe mobile app

- Group messages
- Location sharing
- Quick alerts
- Picture sharing
- For Android

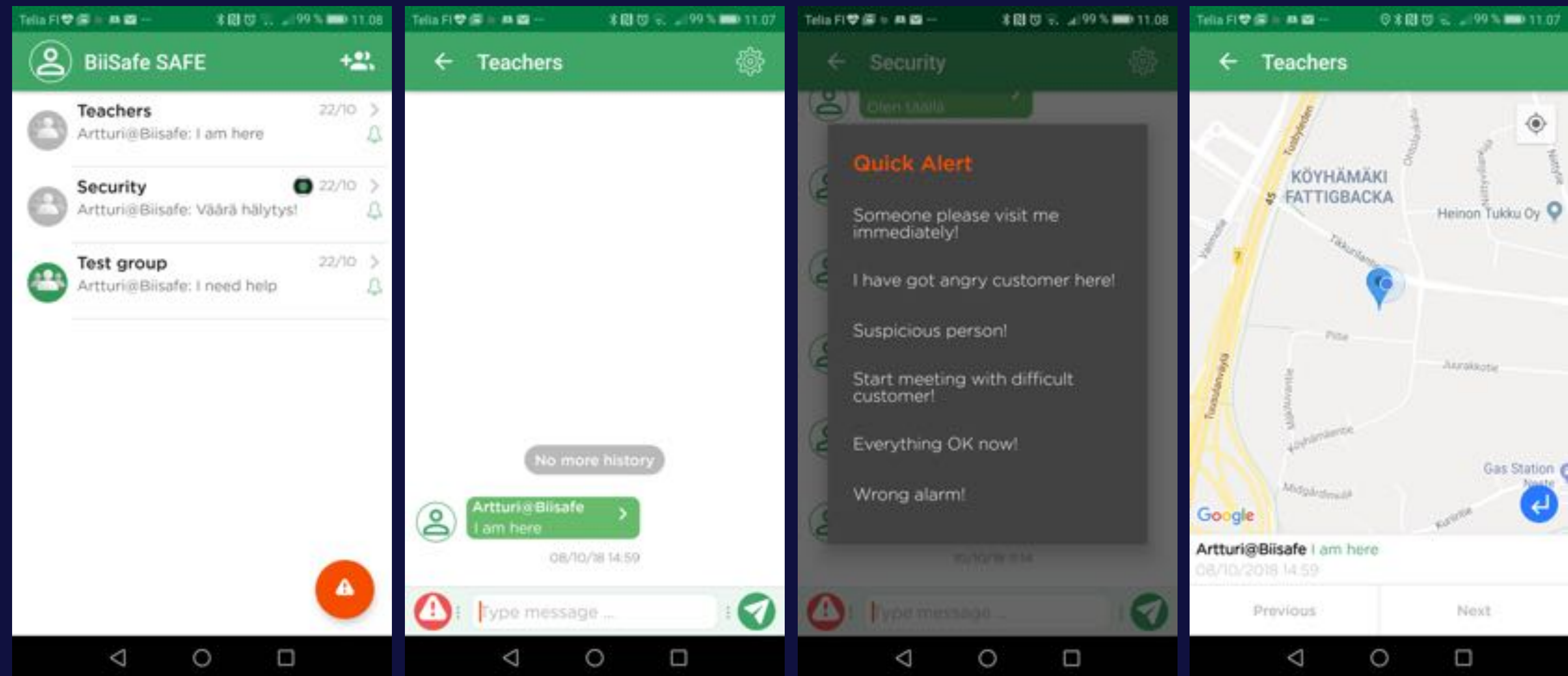

Biisafe Buddy and Card



- Enables quick and unnoticable alert
- Douple press or long press sends the alert message
- Message is sent to preselected group via mobile phine or Biisafe Link
- Can be used as fixed alarm button



Biisafe Buddy



- BLE broadcast
- Can be used to locate people or assets
- Can be used as a fixed alarm button
- Multi press detection
- Accelerometer and step count
- Steel made backplate for branding
- Splash proof
- Replaceable 620mAh battery
- Efficient Bluetooth antenna (range 100m in open space)

BiiSafe Card



- BLE broadcast
- Can be used to locate people or assets
- Possibility to add RFID tag
- Multi press detection
- Accelerometer and step count
- Place for sticker
- Water proof
- Fixed 800mAh battery
- Efficient Bluetooth antenna (range 100m in open space)

Biisafe Link

- ARM 11, 1GHz
- Bluetooth 4.0
- Cover approximately 400m²
- 802.11 WLAN
- Works with Biisafe Safe mobile app and portal
- USB power
- Compatible with Biisafe Buddy and Biisafe Card



Branding



- Brand your tags with the logo of your organization
- It's also possible to have the logo in the mobile app too

Roadmap

- Upcoming features
 - Continuous indoor positioning that can be used to people and asset tracking
 - Management portal for easier administrating
 - Biisafe Safe mobile app for iOS



Prices



- Set Up cost 50€
- Monthly service fee per user 1,90€
- Minimum period 12 months
- Tag and link prices based on the volume

Product	Purchase volume, pcs	Price, €
Buddy	1 - 99	28,1
	100 - 999	23,8
	1000 - 4999	22,5
	> 4999	19,9
Card	1 - 99	31,7
	100 - 999	26,9
	1000 - 4999	25,4
	> 4999	22,4
Link	1 - 99	69,0
	100 - 999	54,7
	1000 - 4999	51,7
	> 4999	45,6

The Company reserves the right to change these prices at any time without prior notice.



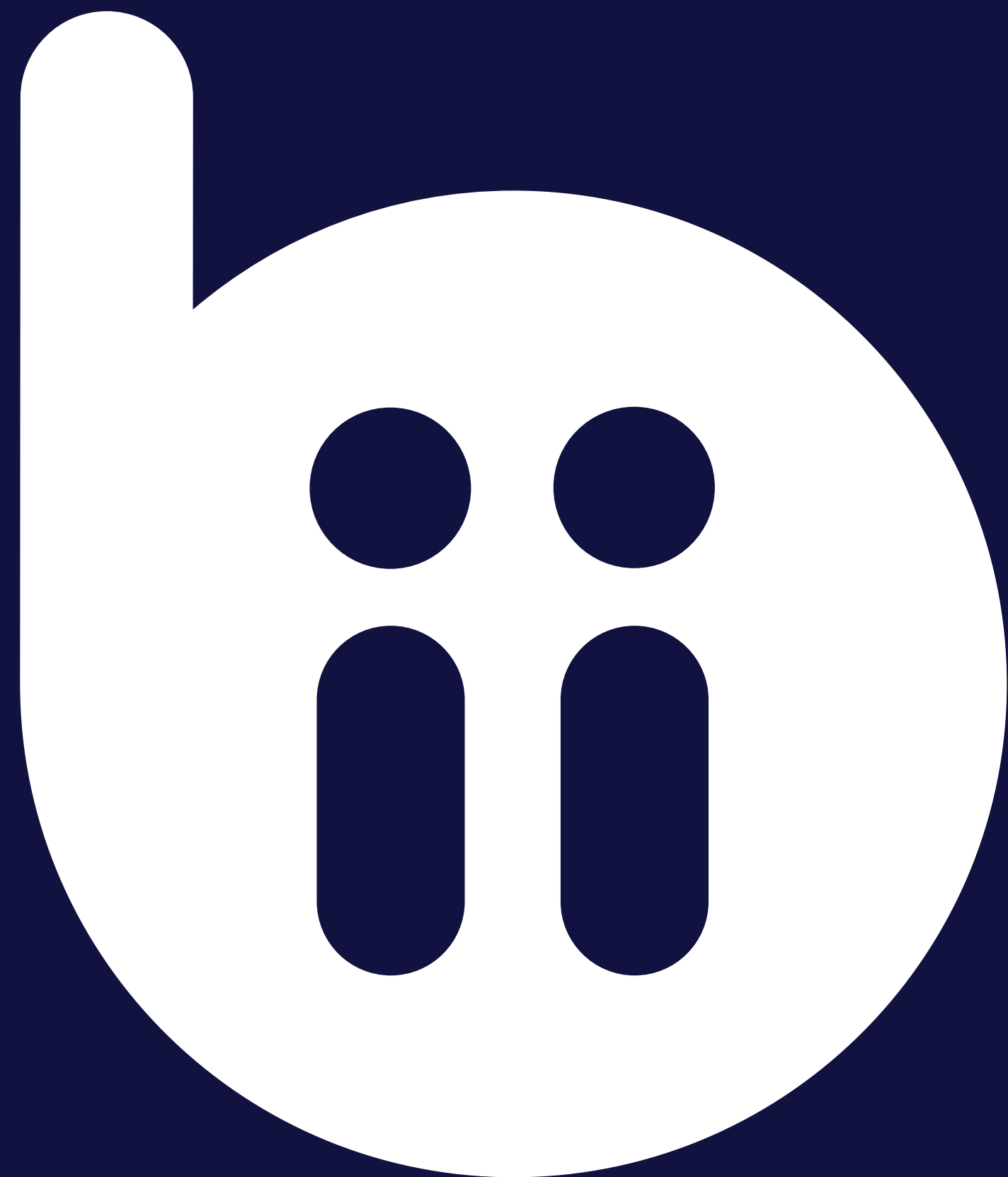

Thank you!

Contact person

Artturi Ketonen

artturi.ketonen@biisafe.com

+358 50 590 2095